

规格：120x167mm

### **Welcome to the world of Two Way Radio !**

Congratulations on your purchase of a high quality Coodio product. Your 2-way radio represents state-of-the-art high-tech engineering. It is a quality piece of electronic equipment, skillfully constructed with the finest components. The circuitry is all solid-state and mounted on a rugged printed circuit board. Your two-way radio is designed for reliable and trouble-free performance for years to come.

## UNPACKING AND CHECKING EQUIPMENT

Carefully unpack the radio. If any of the items listed below are missing or damaged, file a claim with the carrier immediately.

## SUPPLIED ACCESSORIES

◆ Antenna .....	1
◆ AC Adapter .....	1
◆ Charger Dock.....	1
◆ Li-ion Battery .....	1
◆ Belt Clip .....	1
◆ Hand Strap .....	1
◆ User Manual .....	1

## ORIENTATION

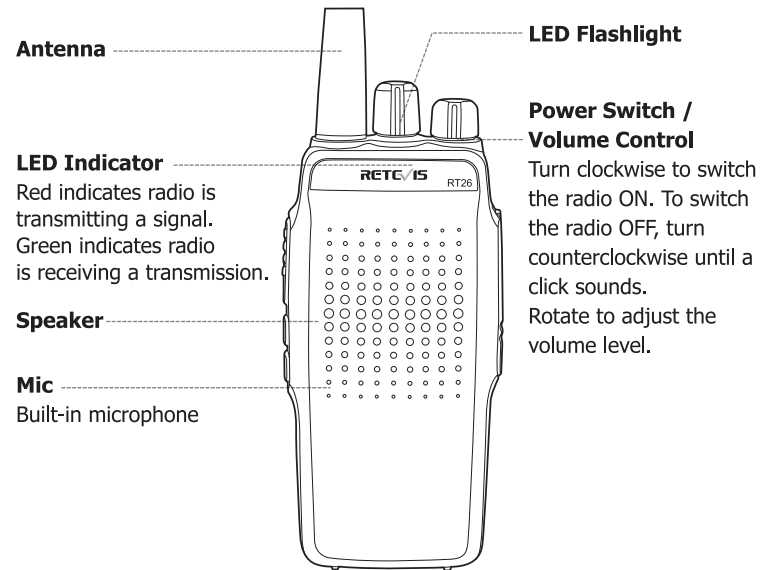

## ORIENTATION

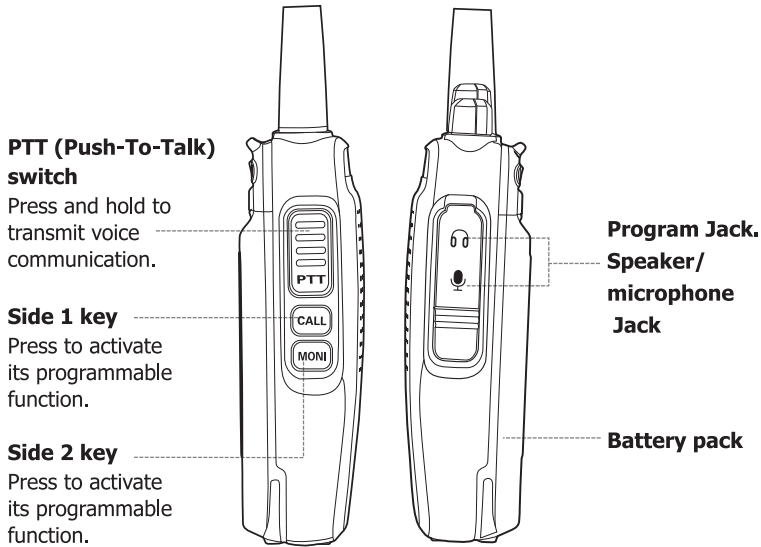

## CHARGING THE BATTERY PACK

This radio is equipped to use a rechargeable Li-ion battery pack which can be recharged by inserting the AC adapter into the radio charge jack. Initial charge time is 24 hours. Charge time is about 8 hours thereafter. For maximum battery life, we recommend charging the battery pack when the low battery icon comes on. Remove the AC adapter from the radio when the charge time expires.

### TO CHARGE BATTERY

- ◆ Check to see that the battery has been inserted properly.
- ◆ Insert the battery or radio into the charger dock.
- ◆ Use only the supplied rechargeable battery and AC adapter for recharging your radio.
- ◆ The radio is not intended to be used while being charged.
- ◆ Non-rechargeable alkaline battery can also be used in your radio.
- ◆ Maximum/Minimum Operating Range: -20°C to +45°C.

### CHARGING STATUS

LED Indicator Color	Status
Blue light ON	In Charging
Blue light OFF	Full Charged

## USE AND CARE

---

1. Use a soft damp cloth to clean the radio.
2. **Do not** use alcohol or cleaning solutions to clean the radio.
3. **Do not** immerse the radio in water.
4. Dry the radio and remove the battery during long-term storage.

## ACCESSORIES INSTALLATION

---

### INSTALLING/REMOVING THE BATTERY PACK

1. To install the battery, put the battery on the back of the radio and slide it towards the upper radio's part
2. To remove the battery, press the "PUSH TO RELEASE" button and slide the battery towards the lower radio's part

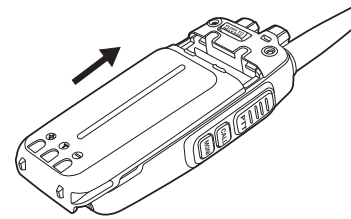

(INSTALLING)

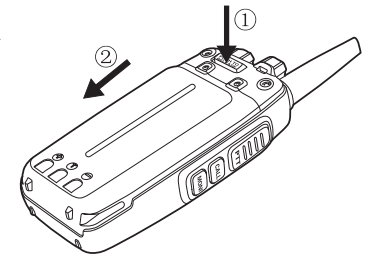

(REMOVING)

## ACCESSORIES INSTALLATION

### INSTALLING THE ANTENNA

Screw the antenna into the connector on the top of the radio by holding the antenna at its base and turning it clockwise until secure.

**Note:** The antenna is neither a handle, a key ring retainer, nor a speaker/microphone attachment point. Using the antenna in these ways may damage the antenna and degrade your radio's performance.

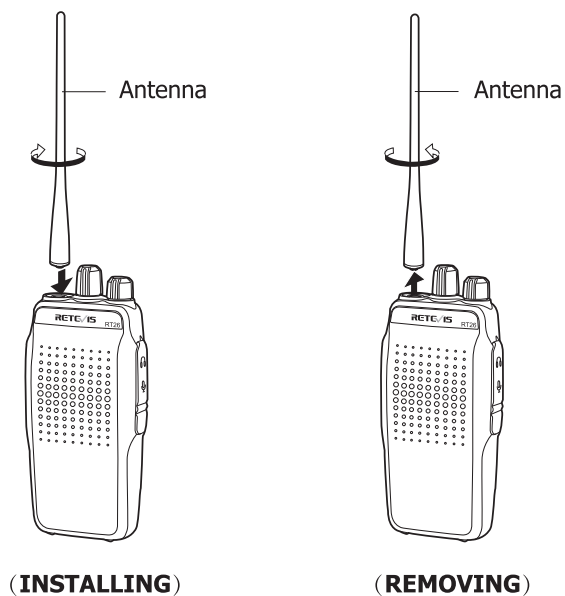

## ACCESSORIES INSTALLATION

### INSTALLING THE BELT CLIP

If necessary, attach the belt clip using the supplied screws.

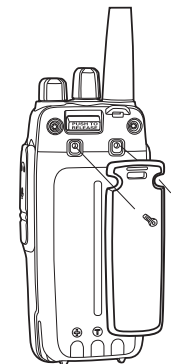

### INSTALLING THE SPEAKER/MICROPHONE (OR HEADSET)

Insert the speaker/microphone (or headset) plugs into the speaker/microphone jack of the radio

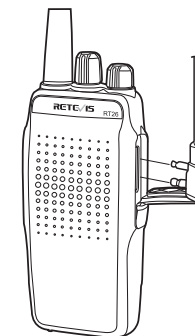

## USING YOUR RADIO

---

### BASIC OPERATIONS

#### 1. POWER SWITCH AND VOLUME CONTROL

Turn clockwise to switch the radio ON. To switch the radio OFF, turn counterclockwise until a click sounds. Rotate to adjust the volume level

#### 2. SELECT THE CHANNEL

Rotate the Channel Selector Knob to choose the Channel you want.

#### 3. TRANSMIT AND RECEIVE

- (1) To make a call, press and hold the PTT switch, then speak around the microphone area using your normal speaking voice. Hold the microphone approximately 1.5 inches (3 to 4 cm) from your lips.
- (2) Release the PTT switch to receive.
- (3) If you set a CTCSS/DCS Code in the radio, you can receive ONLY when the CTCSS/DCS Code is SAME for the radios.

#### 4. SIDE KEY FUNCTION PROGRAM

NOTE: you can program below functions into Side Keys of the radio, please ask the program software from your dealer.

Side Keys (1 & 2) can be programmed as below functions:

- NONE (No function)
- MONITOR
- Monitor Momentary
- High/Low Power Switch
- Scan
- Emergency Alarm
- VOX (Hands-free Transmit)

If side 1 and side 2 key are programmed, you can activate/deactivate below functions according when press the side keys.

#### A. NONE (no function)

## USING YOUR RADIO

---

#### B. MONITOR

You can use the side key Monitor to listen to weak signals that you cannot hear during normal operation, and to adjust the volume when no signals are present on your selected channel.

#### C. MONITOR MOMENTARY

Momentarily press to hear background noise. Press the key again to return to normal operation.

#### D. HIGH/LOW POWER SWITCH

When the side keys are programmed with this function, you can press the key to switch the transmit power between high and low power.

#### E. SCAN

Scan is useful for monitoring signals on the radio channels. When scanning, the radio checks for a signal on each channel and only stops if a signal is present. The radio will remain on a busy channel until the signal is no longer present. Your dealer programs the delay time between signal drop-out and Scan resumption. If a signal is received during the delay time, the radio will remain on the same channel.

#### F. EMERGENCY ALARM

Press the key programmed for Emergency Alarm to enter the Emergency Alarm mode. In the Emergency Alarm Mode, press the key Emergency Alarm Off to quit the Emergency Alarm Mode and disable the alarm tone or stop sending it and resume normal operation.

#### G. VOX (Hands-free Transmit)

VOX operation allows you to transmit hands-free. This feature must first be activated by your dealer, and can only be used if you are using a supported headset. When operating VOX, you must set a VOX Gain

## USING YOUR RADIO

---

level. This setting allows the radio to recognize sound levels. If the microphone is too sensitive, it will begin transmitting when there is noise in the background. If it is not sensitive enough, it will not pick up your voice when you begin speaking. Be sure to adjust the VOX Gain level to an appropriate sensitivity to allow smooth transmission.

### CHANNEL PARAMETERS

#### 1. TX / RX FREQUENCY

You can input the Transmit (TX) frequency and Receive (RX) frequency.

#### 2. CTCSS / DCS CODE (QT/DQT CODE)

Your dealer may have programmed QT or DQT signaling on your radio channels. A QT tone/DQT code is a sub-audible tone/code which allows you to ignore (not hear) calls from other parties who are using the same channel.

When a channel is set up with a QT tone or DQT code, squelch will only open when a call containing a matching tone or code is received. Likewise, signals that you transmit will only be heard by parties whose QT/DQT signaling matches your radio.

If a call containing a different tone or code is made on the same channel you are using, squelch will not open and you will not hear the call. This allows you to ignore (not hear) these calls. Although it may seem like you have your own private channel while using QT/DQT, other parties can still hear your calls if they set up their radio with the same tone or code.

#### 3. TRANSMIT POWER

Choose the transmit power to HIGH or LOW power.

## USING YOUR RADIO

---

#### 4. WIDE/NARROW BAND

Wide Band: Max deviation is 5KHz

Narrow Band: Max deviation is 2.5KHz

#### 5. BATTERY SAVE

If activated by your dealer, the Battery Save function will decrease the amount of power used when a signal is not being received and no operations are being performed (no keys are being pressed, and no switches are being turned).

While the channel is not busy and no operation is performed for 5 seconds, Battery Save turns ON. When a signal is received or an operation is performed, Battery Save turns OFF.

#### 6. PTT-ID

You can name a PTT-ID for each channel so that when DTMF function is activated, you can send the PTT-ID code to others.

#### 7. ADD SCAN CHANNEL

Add the channel to scan list.

#### 8. BUSY CHANNEL LOCKOUT (BCL)

When activated, BCL prevents you from interfering with other parties who may be using the same channel that you selected. Pressing the PTT switch while the channel is in use will cause your radio to emit an alert tone and transmission will be inhibited (you cannot transmit). Release the PTT switch to stop the tone and return to receive mode.

## SHORT-CUT OPERATION

---

### 1. VOX FUNCTION

Select Channel to Channel 1, press and hold [PTT] + [ SIDE KEY 1] and at the same time turn on the radio, VOX function activated, VOX level is Level 1.

Select Channel to Channel 2, press and hold [PTT] + [ SIDE KEY 1] and at the same time turn on the radio, VOX function activated, VOX level is Level 3.

Select Channel to Channel 3, press and hold [PTT] + [ SIDE KEY 1] and at the same time turn on the radio, VOX function activated, VOX level is Level 5.

Select Channel to Channel 4, press and hold [PTT] + [ SIDE KEY 1] and at the same time turn on the radio, VOX function activated, VOX level is Level 7.

Select Channel to Channel 5, press and hold [PTT] + [ SIDE KEY 1] and at the same time turn on the radio, VOX function activated, VOX level is Level 9.

### 2. CHANNEL ANNUNCIATION

When changing the channel using the Channel selector, an audio voice will announce the selected channel number, after you stop changing the channel.

Rotate the channel selector to CHANNEL 10, PRESS and HOLD [PTT] + [ SIDE KEY 1], at the same time turn on the radio to activate / deactivate the CHANNEL ANNUNCIATION function.

### 3. EMERGENCY ALARM

Rotate the channel selector to CHANNEL 11, PRESS and HOLD [PTT] + [ SIDE KEY 1], at the same time turn on the radio to activate / deactivate the EMERGENCY ALARM function.

## SHORT-CUT OPERATION

---

### 4. ANNUNCIATION LANGUAGE

Rotate the channel selector to CHANNEL 15, PRESS and HOLD [PTT] + [ SIDE KEY 1], at the same time turn on the radio to switch the language between Chinese and English.



## OTHER FUNCTIONS

### 1. TIME-OUT TIMER (TOT)

The purpose of the Time-out Timer is to prevent any caller from using a channel for an extended period of time.

If you continuously transmit for a period of time that exceeds the programmed time set by your dealer (default is 1 minute), the radio will stop transmitting and an alert tone will sound.

To stop the tone, release the PTT switch.

### 2. LOW BATTERY WARNING

Low Battery Warning alerts you when the battery needs to be recharged or replaced.

While operating the radio, if the battery power becomes low, an alert tone will sound every 30 seconds and the LED indicator will blink red. Replace or recharge the battery pack.

## Trouble shooting

Before the transceiver is regarded as being faulty, please double check according to the main problems as following chart. If the problems are still happening, please reset it to avoid some misfunctional operation, search assistance from the experienced technician or contact your buyer accordingly.

<i><b>Problem</b></i>	<i><b>Solution</b></i>
The transceiver can not be powered on.	<i>1.</i> The battery may be exhausted, pls change the new battery or re-charge it. <i>2.</i> The battery was not installed correctly, pls re-install.
The battery life is too short to use.	<i>1.</i> The battery life is over, pls change a new battery. <i>2.</i> The battery is not fully charge.
The receiving light keeps flashing, but there is no sound coming out.	<i>1.</i> Make sure the volume is highest. <i>2.</i> Make sure the CTCSS/DCS settings are the same as the transmitting transceiver.
It seems the keyboard does not work.	<i>1.</i> Make sure the keypad is locked or not. <i>2.</i> Make sure the keys are not stuck.

<i><b>Problem</b></i>	<i><b>Solution</b></i>
In standby, the transceiver will transmit automatically even the PTT key is not pressed	Make sure VOX function is ON or not, and its level is set too low or not.
Some functions can not be stored normally.	Please confirm if the transceiver is working in channel mode, since some functions are ONLY set in frequency mode via programming software.
There are other disturbed signals or noise( from other groups) in the channel.	Please change the CTCSS/DCS frequencies set in your group.

## SPECIFICATION

---

General	
Channel Capacity	16
Channel Spacing	25/12.5KHz
Frequency Stability	±2.5ppm
Operating Temperature	-20 °C ~ +50 °C
Antenna Impedance	50Ω
Dimensions(with battery, without antenna) (L×W×H)	123×61×39mm
Weight(with antenna & battery)	225g
Transmitter	
Modulation	16K X F3E
Audio Distortion	≤5 %
General	
Sensitivity	0.25μV
Rated Audio	400mW
Rated Audio Distortion	≤5%

All Specifications are subject to change without notice due to continuous development.